

## Stainless Steel Screws

**Hygienic Design, Low-Profile Head, with Recessed Stud for Loss Protection**

### SPECIFICATION

Stainless steel

- AISI 316 L
- Matte (Ra < 0.8 µm) **MT**
- Polished (Ra < 0.8 µm) **PL**

Sealing ring

H-NBR **H**

Temperature resistant -25 °C to +150 °C

EPDM **E**

Temperature resistant -40 °C to +120 °C

- Blue
- Hardness 85±5 Shore A
- FDA compliant



### INFORMATION

Stainless steel screws GN 1582 with low-profile head are ideal for use in hygienic areas. Due to the d4 recessed stud, they are easily secured against loss, such as in a cover. Thus the „captivity of the mounting element“ according to the Machinery Directive 2006 / 42 / EG is given.

When using, instead of a typical tapped and bore hole, it is necessary to provide tapped bores with a thread d1 on each of the two elements to be assembled. Additionally, a clearance bore of d5 on one or both sides must be cut. Depending on the design and required clamping length a1 ... a3 of the component being attached, there are a number of assembly options as shown above. Alternatively, securing can also be achieved by an additional lock washer mounted on the thin shank d4.

### TECHNICAL INFORMATION

- Stainless Steel characteristics (see page A26)
- Elastomer characteristics (see page A32)

### ON REQUEST

- Screws with additional lock washer (Identification no. 2)

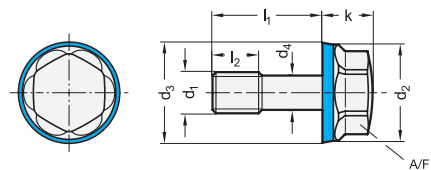

Assembly options

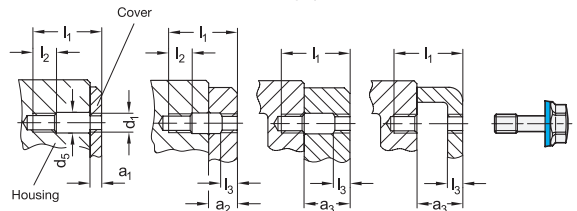

\* Complete with type index of the Stainless Steel Screws

**MT** Polished  
Matte

### GN 1582

STAINLESS STEEL

Description	d1	l1	a1	a2	a3	d2	d3	d4-0.2	d5	k	l2	l3	A/F	⚖
GN 1582-M5-20-*-H-1	M 5	20	2.5-6	6-10.5	10.5-14	11	11.8	4	5.5	7	6	2.5	8	5
GN 1582-M5-20-*-E-1	M 5	20	2.5-6	6-10.5	10.5-14	11	11.8	4	5.5	7	6	2.5	8	5
GN 1582-M5-25-*-H-1	M 5	25	6-11	11-14	14-19	11	11.8	4	5.5	7	6	2.5	8	6
GN 1582-M5-25-*-E-1	M 5	25	6-11	11-14	14-19	11	11.8	4	5.5	7	6	2.5	8	6
GN 1582-M6-25-*-H-1	M 6	25	3-7	7-13	13-17	13	13.8	4.8	6.5	7.5	8	3	10	9
GN 1582-M6-25-*-E-1	M 6	25	3-7	7-13	13-17	13	13.8	4.8	6.5	7.5	8	3	10	9
GN 1582-M6-30-*-H-1	M 6	30	7-12	12-17	17-22	13	13.8	4.8	6.5	7.5	8	3	10	10
GN 1582-M6-30-*-E-1	M 6	30	7-12	12-17	17-22	13	13.8	4.8	6.5	7.5	8	3	10	10
GN 1582-M8-30-*-H-1	M 8	30	4-8	8-16	16-20	16	16.8	6.5	8.5	8.5	10	4	13	18
GN 1582-M8-30-*-E-1	M 8	30	4-8	8-16	16-20	16	16.8	6.5	8.5	8.5	10	4	13	18
GN 1582-M8-40-*-H-1	M 8	40	8-18	18-25	25-30	16	16.8	6.5	8.5	8.5	10	4	13	21
GN 1582-M8-40-*-E-1	M 8	40	8-18	18-25	25-30	16	16.8	6.5	8.5	8.5	10	4	13	21
GN 1582-M10-40-*-H-1	M 10	40	5-14	14-19	19-28	19	19.8	8.2	10.5	9.5	12	5	16	34
GN 1582-M10-40-*-E-1	M 10	40	5-14	14-19	19-28	19	19.8	8.2	10.5	9.5	12	5	16	34
GN 1582-M10-50-*-H-1	M 10	50	14-24	24-28	28-38	19	19.8	8.2	10.5	9.5	12	5	16	39
GN 1582-M10-50-*-E-1	M 10	50	14-24	24-28	28-38	19	19.8	8.2	10.5	9.5	12	5	16	39

Weight type MT